

横 断 図  
S=1:100

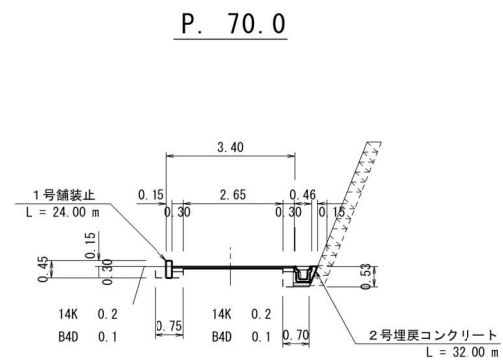

P. 50.0

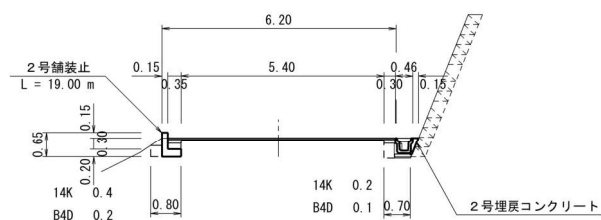

P. 40.0

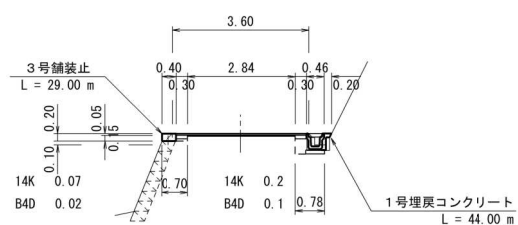

詳細図  
 S=1:50

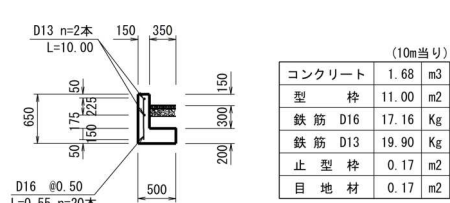
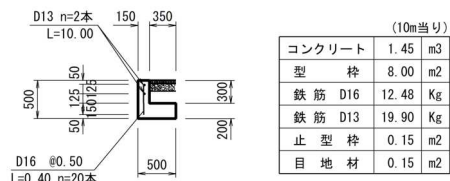
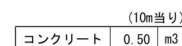
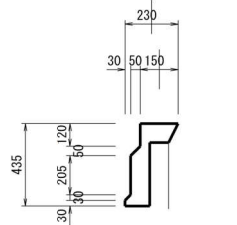
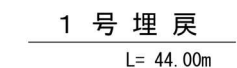
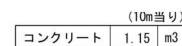
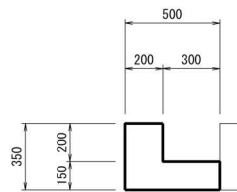
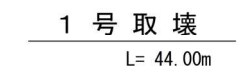
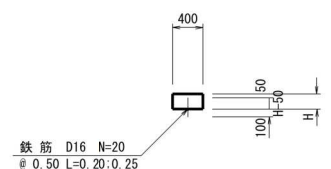
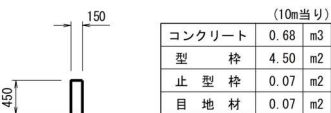
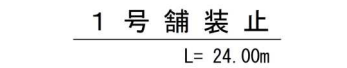

詳 細 図  
S=1:20

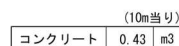
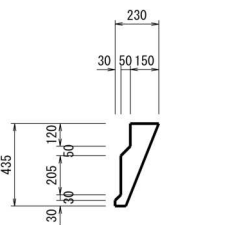
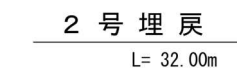
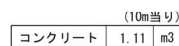
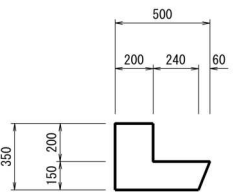
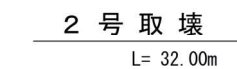

平面图

S=1:1,000

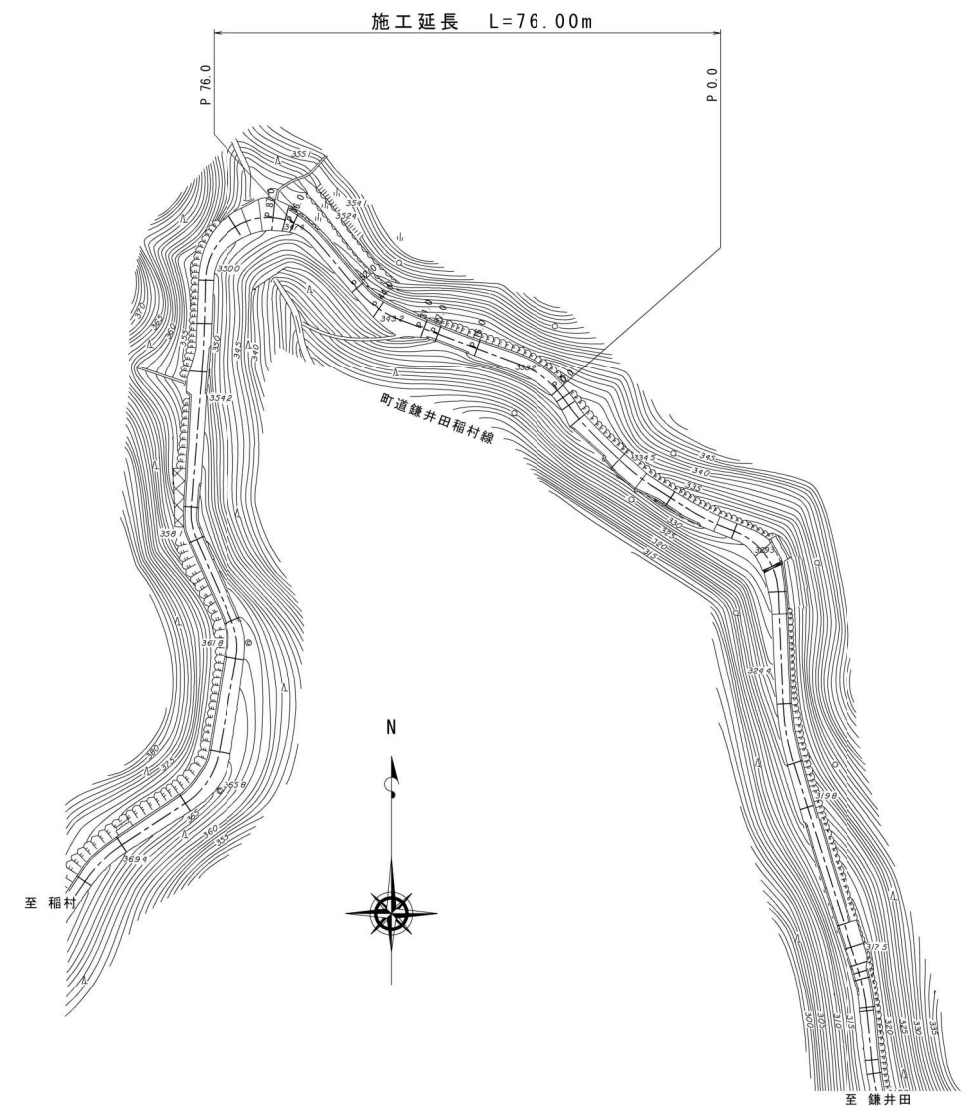

As 舖 装

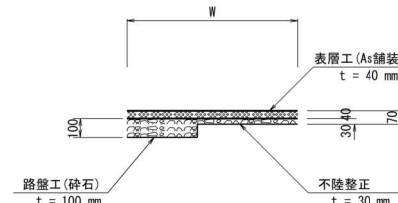

### 実 施 図

高知県 越知町			
施工年度	令和4年度	工事番号	令3防安第12号
工事名	町道鎌井田稲村線修防災・安全対策交付金工事③		
図面名称	横断図・詳細図・平面図		
図面番号	1 / 2	縮 尺	図 示
路線名	町道鎌井田稲村線		
工事場所	高岡郡 越知町 鎌井田本村(杉ノ藪)		